



4 Bed  
House - Terraced  
located in

£420,000



TAYLOR  
MICHAEL



# The Byway

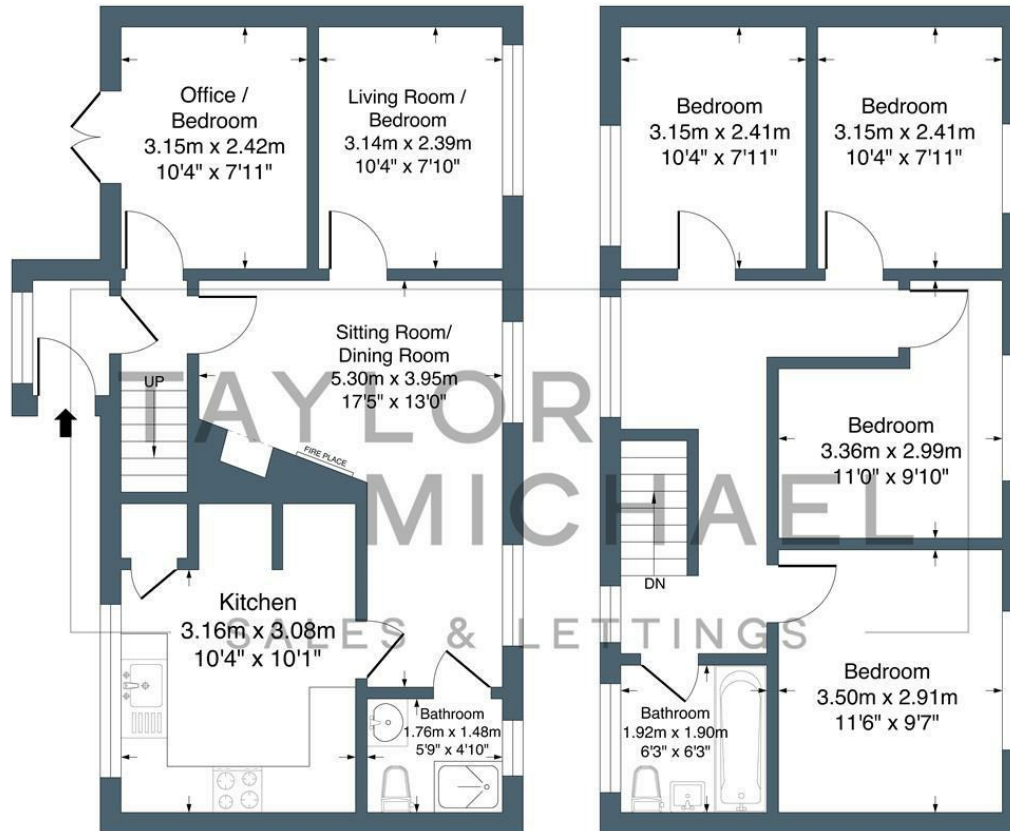

Ground Floor  
Approximate Floor Area  
564.73 sq.ft  
(52.46 sq.m)

First Floor  
Approximate Floor Area  
546.17 sq.ft  
(50.74 sq.m)

Illustration for identification purposes only, measurements are approximate, not to scale.

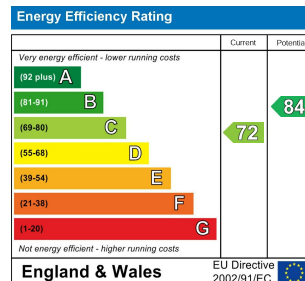

## DIRECTIONS

## CONTACT

62 Church Road  
Hove  
East Sussex  
BN3 2FP

E: [lettings@taylormichael.agency](mailto:lettings@taylormichael.agency)  
T: 01273 600100  
<https://taylormichael.agency/>

**TAYLOR**  
**MICHAEL**